

CPU-PCB (FOIL SIDE)

SYMBOL NO.	ADDRESS
D302	B- 1
D303	B- 1
D304	B- 1
D305	B- 1
D306	B- 1
D307	B- 1
D308	B- 1
D309	C- 2
D310	C- 2
IC301	B- 4
IC302	C- 5
IC303	B- 5
IC304	B- 5
IC305	B- 6
IC306	B- 6
IC307	C- 2
IC308	C- 3
IC309	C- 3
IC310	C- 2
IC311	C- C
IC312	C- 3
IC313	B- 2
IC314	B- 7

SYMBOL NO.	ADDRESS
L325	A- 4
L326	A- 3
L327	A- 3
L328	A- 3
Q301	C- 5
Q302	C- 3
Q303	C- 3
Q304	C- 4
Q306	A- 1
Q307	C- 2
Q308	C- 2
Q309	C- 2
Q310	A- 1
Q311	A- 2
Q312	B- 4
Q313	B- 2
Q314	B- 2
Q315	D- 7
Q316	D- 6

SYMBOL NO.	ADDRESS
TP30	A- 1
TP31	A- 1
TP32	A- 1
VR30	A- 1
VR302	A- 1

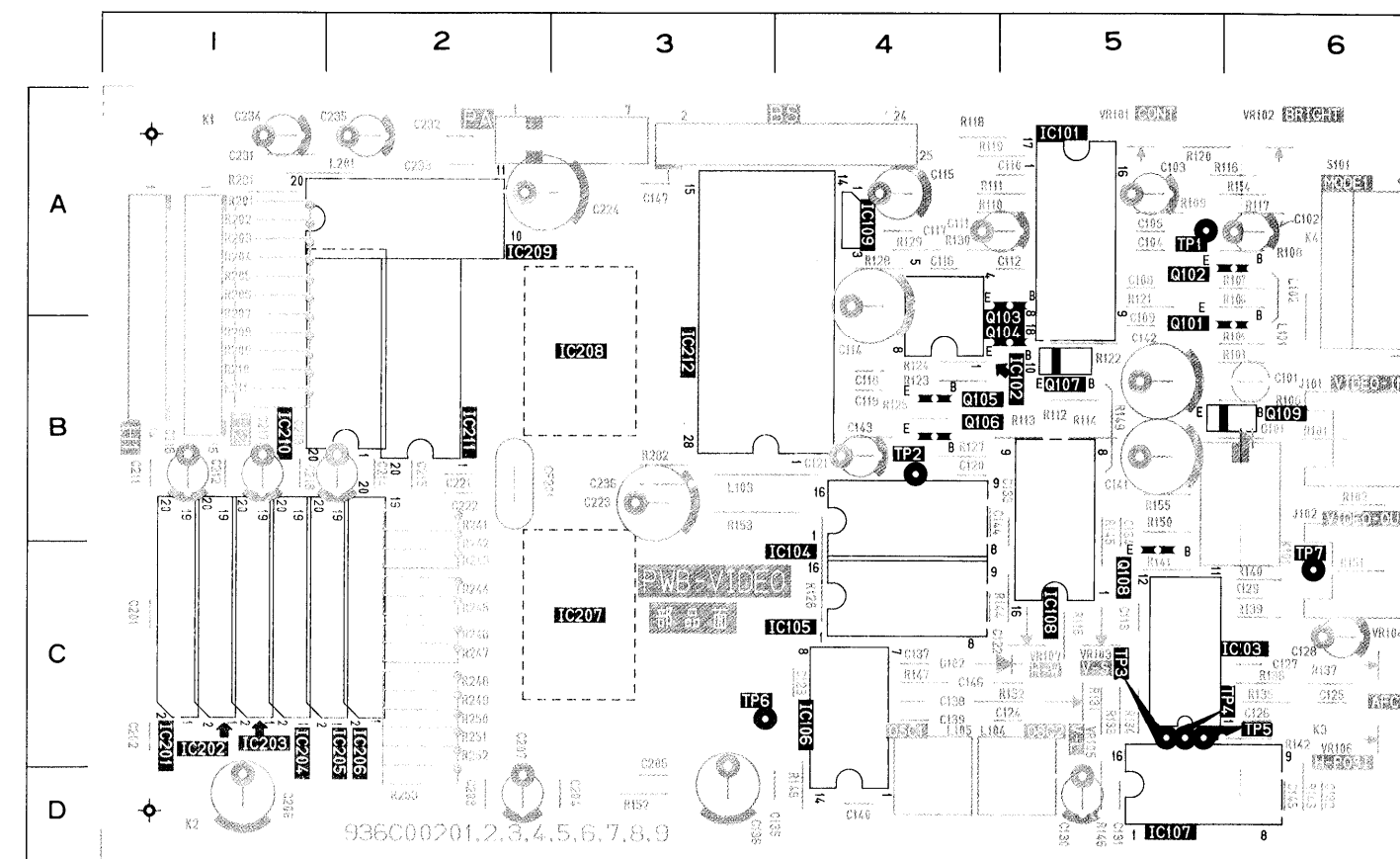

VIDEO-PCB (PARTS SIDE)

SYMBOL NO.	ADDRESS
D101	B- 6
D102	C- 4
IC101	A- 5
IC102	B- 4
IC103	C- 5
IC104	C- 4
IC105	C- 4
IC106	C- 4
IC107	D- 5
IC108	C- 5
IC109	A- 4
IC201	C- 1
IC202	C- 1
IC203	C- 1
IC204	C- 1
IC205	C- 2
IC206	C- 2
IC207	C- 3
IC208	B- 3
IC209	A- 2
IC210	B- 2
IC211	B- 2
IC212	B- 3

SYMBOL NO.	ADDRESS
L101	B- 6
L102	B- 6
L103	B- 3
L104	C- 5
L105	C- 4
L201	A- 1
Q101	B- 5
Q102	B- 5
Q103	B- 5
Q104	B- 5
Q105	B- 4
Q106	B- 4
Q107	B- 5
Q108	C- 5
Q109	B- 5

SYMBOL NO.	ADDRESS
TP1	A- 5
TP2	B- 4
TP3	C- 5
TP4	C- 5
TP5	C- 5
TP6	C- 3
TP7	C- 6
VR101	A- 5
VR102	A- 6
VR103	C- 5
VR104	C- 6
VR105	C- 5
VR106	C- 6
VR107	C- 5

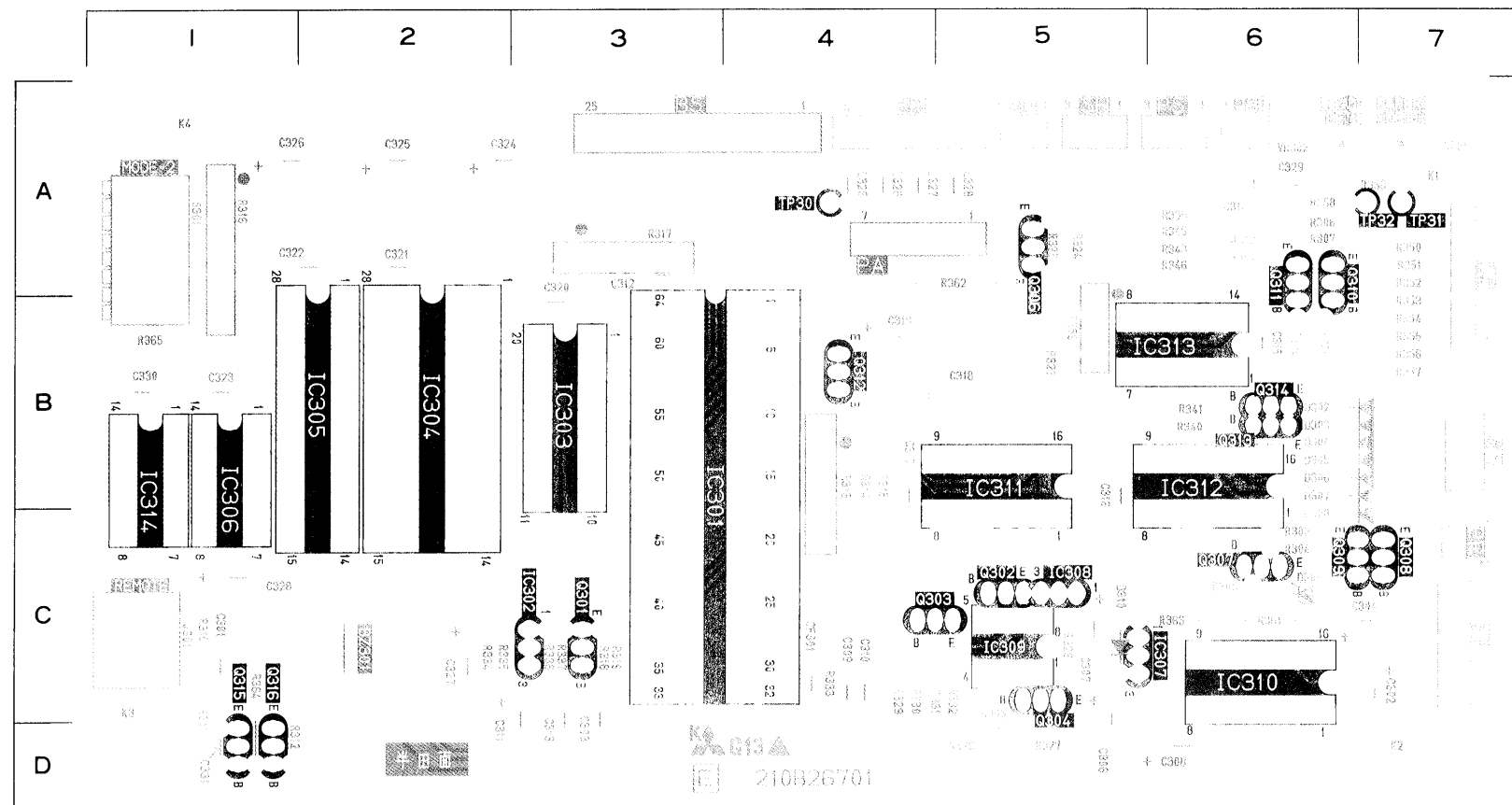

CPU-PCB (PARTS SIDE)

SYMBOL NO.	ADDRESS
D302	B- 6
D303	B- 6
D304	B- 6
D305	B- 6
D306	B- 6
D307	C- 6
D308	C- 6
D309	C- 6
D310	C- 5
IC301	C- 3
IC302	C- 3
IC303	B- 3
IC304	B- 2
IC305	B- 2
IC306	C- 1
IC307	C- 6
IC308	C- 5
IC309	C- 5
IC310	C- 6
IC311	C- 5
IC312	C- 6
IC313	B- 6
IC314	C- 1

SYMBOL NO.	ADDRESS
L325	A- 4
L326	A- 4
L327	A- 4
L328	A- 5
Q301	C- 3
Q302	C- 5
Q303	C- 5
Q304	D- 5
Q306	B- 5
Q307	C- 6
Q308	C- 7
Q309	C- 6
Q310	B- 6
Q311	B- 6
Q312	B- 4
Q313	B- 6
Q314	B- 6
Q315	C- 1
Q316	C- 1

SYMBOL NO.	ADDRESS
TP30	A- 4
TP31	A- 7
TP32	A- 7
VR301	A- 7
VR302	A- 6

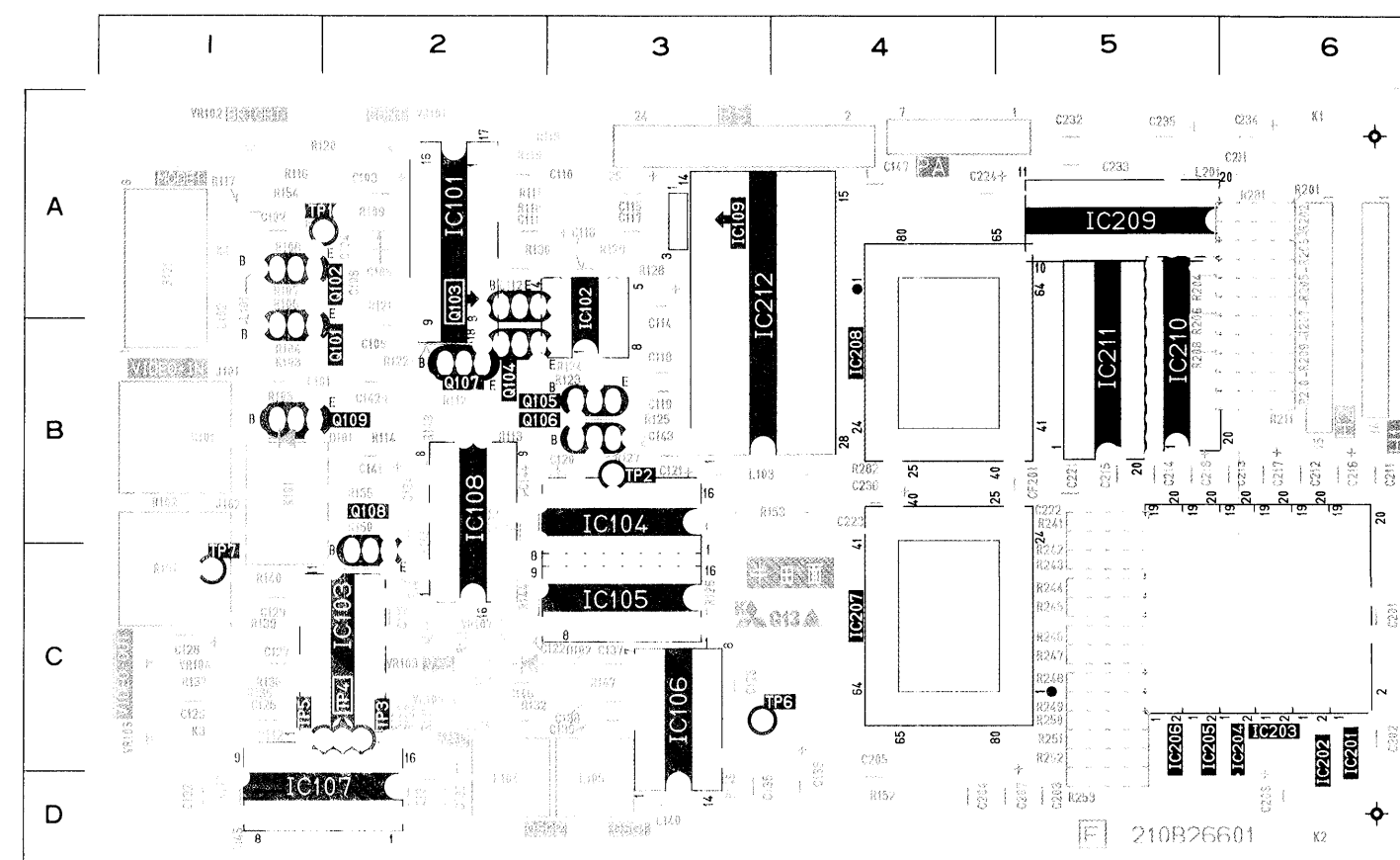

VIDEO-PCB (FOIL SIDE)

SYMBOL NO.	ADDRESS
D101	B- 2
D102	C- 3
IC101	A- 2
IC102	A- 3
IC103	C- 2
IC104	B- 3
IC105	C- 3
IC106	C- 3
IC107	D- 2
IC108	B- 2
IC109	A- 3
IC201	C- 6
IC202	C- 6
IC203	C- 6
IC204	C- 6
IC205	C- 5
IC206	C- 5
IC207	C- 4
IC208	B- 4
IC209	A- 5
IC210	B- 5
IC211	B- 5
IC212	B- 4

SYMBOL NO.	ADDRESS
L101	A- 1
L102	A- 1
L103	B- 4
L104	D- 2
L105	D- 3
L201	A- 5
Q101	B- 2
Q102	A- 2
Q103	A- 2
Q104	B- 2
Q105	B- 3
Q106	B- 3
Q107	B- 2
Q108	B- 2
Q109	B- 2

SYMBOL NO.	ADDRESS
TP1	A- 2
TP2	B- 3
TP3	C- 2
TP4	C- 2
TP5	C- 2
TP6	C- 3
TP7	C- 1
VR101	A- 2
VR102	A- 1
VR103	C- 2
VR104	C- 1
VR105	C- 2
VR106	C- 1
VR107	C- 2

PCB-POWER

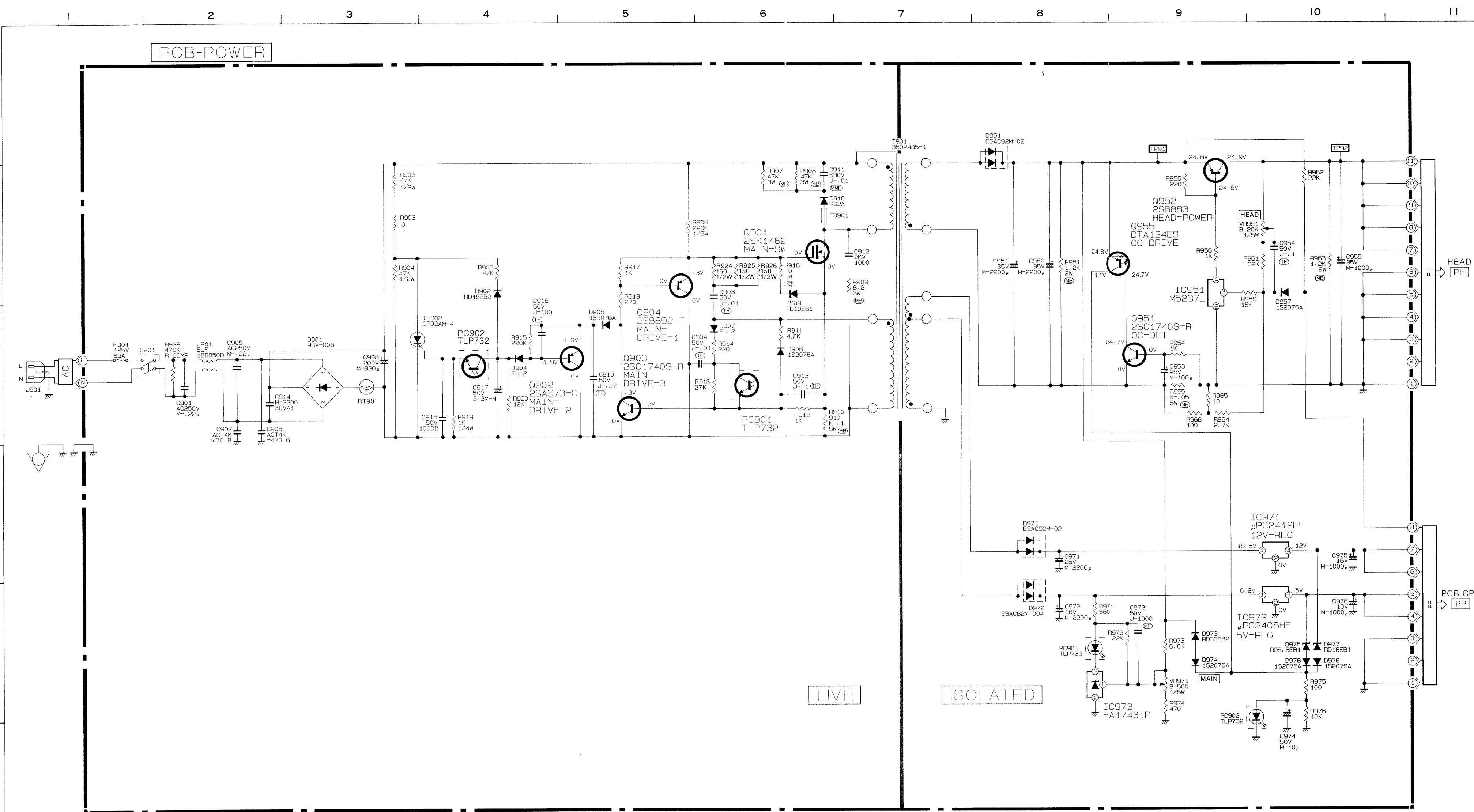

LIVE

ISOLATED

HEAD PH

PCB-CPU PP

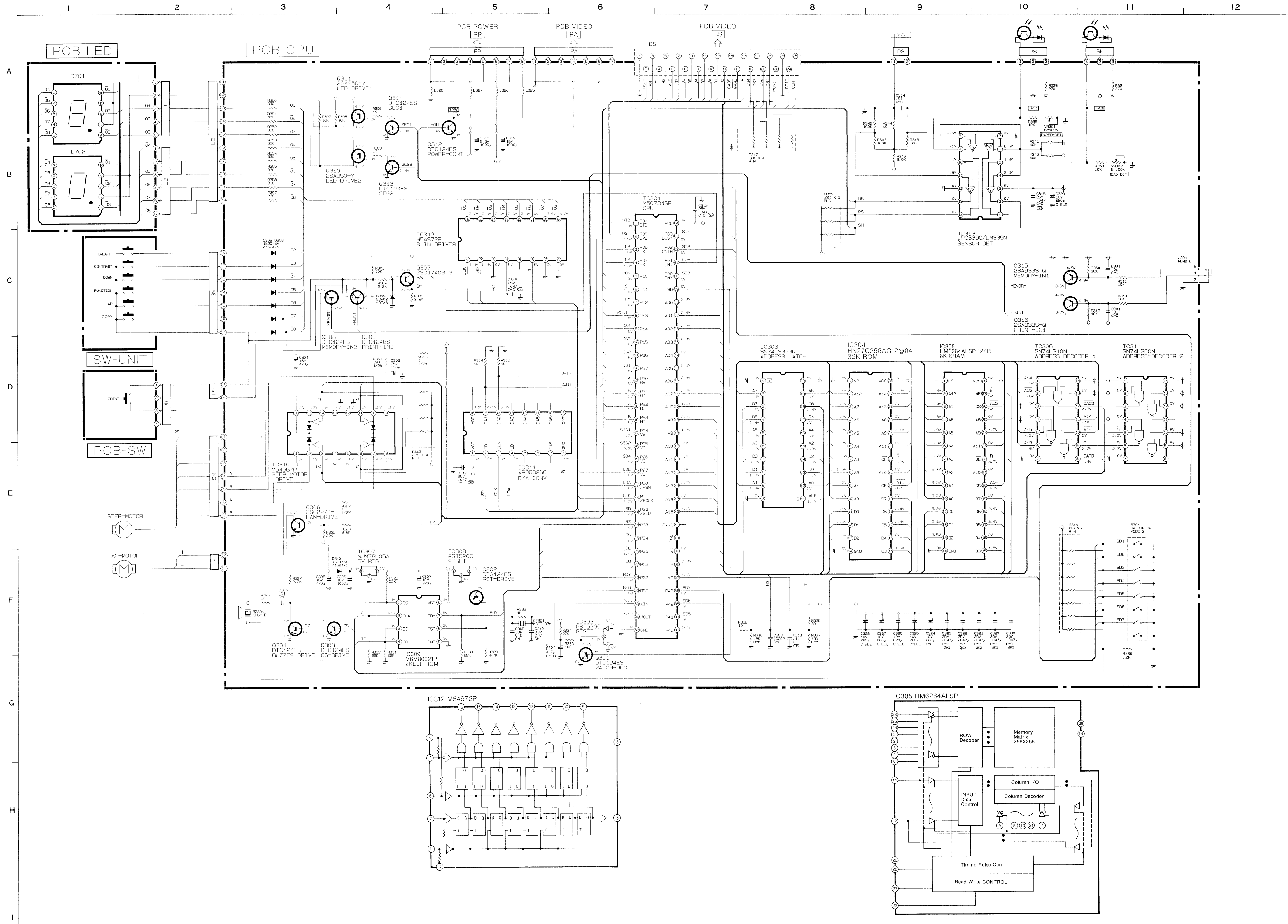

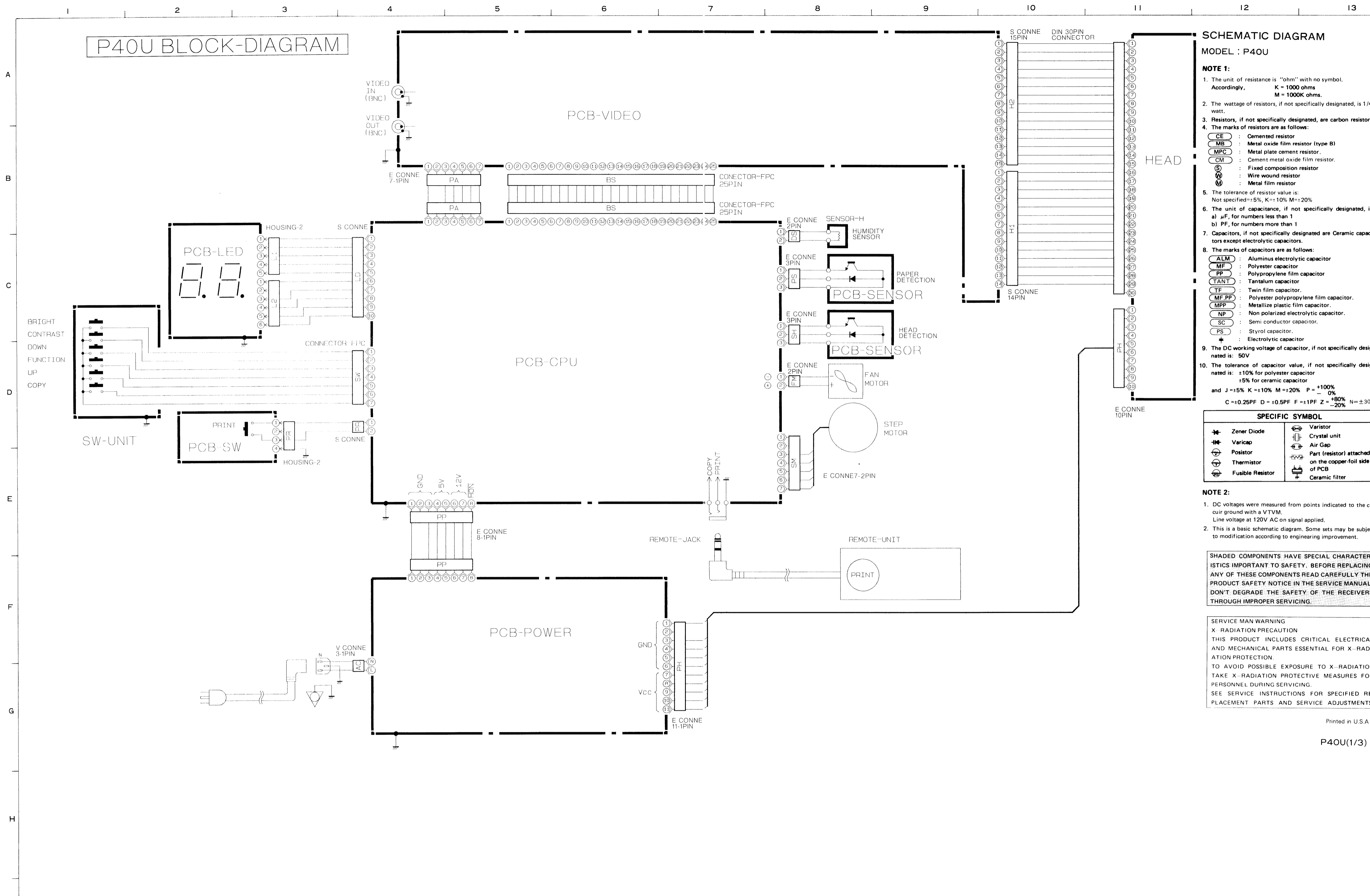

P40U BLOCK-DIAGRAM

SCHEMATIC DIAGRAM

MODEL : P40U

- NOTE 1:**
- The unit of resistance is "ohm" with no symbol. Accordingly, K = 1000 ohms, M = 1000K ohms.
 - The wattage of resistors, if not specifically designated, is 1/4 watt.
 - Resistors, if not specifically designated, are carbon resistors.
 - The marks of resistors are as follows:
 - CE : Cemented resistor
 - MB : Metal oxide film resistor (type B)
 - MPC : Metal plate cement resistor.
 - CM : Cement metal oxide film resistor.
 - S : Fixed composition resistor
 - W : Wire wound resistor
 - M : Metal film resistor
 - The tolerance of resistor value is: Not specified = ±5%, K = ±10% M = ±20%
 - The unit of capacitance, if not specifically designated, is: a) μF, for numbers less than 1 b) PF, for numbers more than 1
 - Capacitors, if not specifically designated are Ceramic capacitors except electrolytic capacitors.
 - The marks of capacitors are as follows:
 - ALM : Aluminum electrolytic capacitor
 - MF : Polyester capacitor
 - PP : Polypropylene film capacitor
 - TANT : Tantalum capacitor
 - TF : Twin film capacitor.
 - MP, PP : Polyester polypropylene film capacitor.
 - MPP : Metallize plastic film capacitor.
 - NP : Non polarized electrolytic capacitor.
 - SC : Semi conductor capacitor.
 - PS : Styrol capacitor.
 - *
 - The DC working voltage of capacitor, if not specifically designated is: 50V
 - The tolerance of capacitor value, if not specifically designated is: ±10% for polyester capacitor ±5% for ceramic capacitor and J = ±5% K = ±10% M = ±20% P = +100% - 0% C = ±0.25PF D = ±0.5PF F = ±1PF Z = +80% -20% N = ±30%

SPECIFIC SYMBOL	

- NOTE 2:**
- DC voltages were measured from points indicated to the circuit ground with a VTVM. Line voltage at 120V AC on signal applied.
 - This is a basic schematic diagram. Some sets may be subject to modification according to engineering improvement.

SHADED COMPONENTS HAVE SPECIAL CHARACTERISTICS IMPORTANT TO SAFETY. BEFORE REPLACING ANY OF THESE COMPONENTS READ CAREFULLY THE PRODUCT SAFETY NOTICE IN THE SERVICE MANUAL. DON'T DEGRADE THE SAFETY OF THE RECEIVERS THROUGH IMPROPER SERVICING.

SERVICE MAN WARNING
 X-RADIATION PRECAUTION
 THIS PRODUCT INCLUDES CRITICAL ELECTRICAL AND MECHANICAL PARTS ESSENTIAL FOR X-RADIATION PROTECTION.
 TO AVOID POSSIBLE EXPOSURE TO X-RADIATION TAKE X-RADIATION PROTECTIVE MEASURES FOR PERSONNEL DURING SERVICING.
 SEE SERVICE INSTRUCTIONS FOR SPECIFIED REPLACEMENT PARTS AND SERVICE ADJUSTMENTS.

ISOLATED

F901 AC125V 5A

LIVE

FLCMK-140X

SM-PWR S901

AC

PWB-POWER

210B26901

MAIN VR971 HEAD VR951

PH

PP

TP92

TP91

Q952

IC971

IC912

Q951

Q951

Q955

IC973

IC951

PC901

PC902

Q902

Q904

Q903

Q901

R963

R958

R956

C955

C975

C976

D975

D978

D977

D976

C971

D971

D972

8

16

+

+

+

C951

C952

C953

R951

+

+

+

+

+

R961

R962

R954

R955

R966

R965

R973

R972

R971

R974

R975

R976

R977

R978

R979

R980

R981

R982

R983

R984

R985

R986

R987

R988

R989

R990

R991

R992

R993

R994

R995

R996

R997

C974

C975

C976

C977

C978

C979

C980

C981

C982

C983

C984

C985

C986

C987

C988

C989

C990

C991

C992

C993

C994

C995

C996

C997

D957

D958

D959

D960

D961

D962

D963

D964

D965

D966

D967

D968

D969

D970

D971

D972

D973

D974

D975

D976

D977

D978

D979

D980

TH901

TH902

TH903

TH904

TH905

TH906

TH907

TH908

TH909

TH910

TH911

TH912

TH913

TH914

TH915

TH916

TH917

TH918

TH919

TH920

TH921

TH922

TH923

TH924

R901

R902

R903

R904

R905

R906

R907

R908

R909

R910

R911

R912

R913

R914

R915

R916

R917

R918

R919

R920

R921

R922

R923

R924

R925

R926

R927

R928

R929

R930

R931

R932

R933

R934

R935

R936

R937

R938

R939

R940

R941

R942

R943

R944

R945

R946

R947

R948

R949

R950

R951

R952

R953

R954

R955

R956

R957

R958

R959

R960

R961

R962

R963

R964

R965

R966

R967

R968

R969

R970

R971

R972

R973

R974

R975

R976

R977

R978

R979

R980

R981

R982

R983

R984

R985

R986

R987

R988

R989

R990

R991

R992

R993

R994

R995

R996

C997

C998

C999

C1000

C1001

C1002

C1003

C1004

C1005

C1006

C1007

C1008

C1009

C1010

C1011

C1012

C1013

C1014

C1015

C1016

C1017

C1018

C1019

C1020

C1021

C1022

C1023

C1024

C1025

C1026

C1027

C1028

C1029

C1030

C1031

C1032

C1033

C1034

C1035

C1036

C1037

C1038

C1039

C1040

C1041

C1042

C1043

C1044

C1045

C1046

C1047

C1048

C1049

C1050

C1051

C1052

C1053

C1054

C1055

C1056

C1057

C1058

C1059

C1060

C1061

C1062

C1063

C1064

C1065

C1066

C1067

C1068

C1069

C1070

C1071

C1072

C1073

C1074

C1075

C1076

C1077

C1078